

SCP Part No. 10G-FPS

10G Rated RJ45 Field Plug - Ultra Slim –
Fully Shielded for Cat6/6a/7a Shielded LAN
cables, Toolless, 1 Piece Design, Re-usable.

ISO/IEC 11801, Class Fa, F, Ea, E, ANSI/TIA 568.2-D,
PoE/PoH IEEE 802.3bt Type 1-4
Supports cable diameter: 6.0 - 9.0 mm

Instruction Manual

| JACK PIN DESIGNATIONS | TIA / EIA T568A | | TIA / EIA T568B | INDUSTRIAL |
|-----------------------------|--------------------|--------------|--------------------|------------|
| | 1 | White/Green | White/Orange | Yellow |
| | 2 | Green | Orange | Orange |
| | 3 | White/Orange | White/Green | White |
| | 6 | Orange | Green | Blue |
| | 4 | Blue | Blue | |
| | 5 | White/Blue | White/Blue | |
| | 7 | White/Brown | White/Brown | |
| | 8 | Brown | Brown | |

Cable Preparation

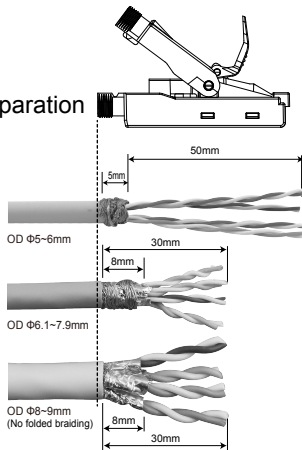

①

Slide metal cable gland with black nylon cable bushing onto the cable. Follow cable preparation as shown. Fan out all 4 twisted pairs and cut the conductors as shown.

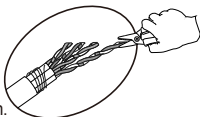

Note:

- Make sure nylon cable bushing is facing correctly as shown to the right.
 - Nylon cable bushing has slit to allow proper tightening during final stage of screwing the metal cable gland to the connector.
- Cable busing may be removed on cable OD >8mm.

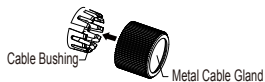

②

Follow the color-coded wire pattern label and align each conductor into proper slot on wiring cap. Using flush cutter, trim wires flush with wiring cap.

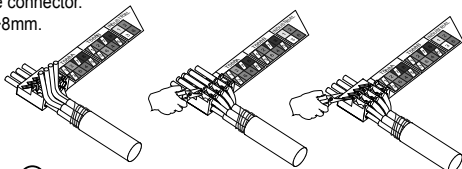

③

Remove wiring label before placing wiring cap on connector.

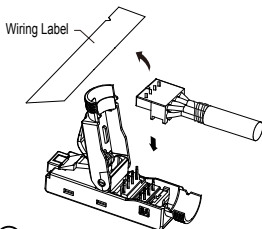

④

Place wiring cap onto IDC terminal and press firmly down. Ensure drain wire or braiding is in contact with grounding clip. See illustration.

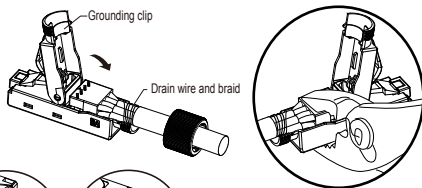

⑤

Make sure drain wire is not stuck between housing as you close plug cover firmly down. Screw on the cable gland with inserted bushing to complete installation.

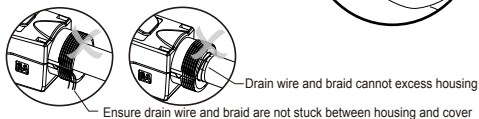

Unload the cable

