



Structured Cable Products®
Quality Installations Deserve Quality Products

CAT6A-SH-JACK-WT

10GBaseT RJ45 Shielded Keystone Jack for Cat6a/7a,
Toolless, Narrow Width, Zinc Alloy Metal Shell, ANSI/TIA 568-2.D
ISO/IEC 11801 Class Ea , 8P8C- White Clip- 1ea/bag

TERMINATION INSTRUCTIONS

JACK PIN DESIGNATIONS		TIA / EIA T568A	TIA / EIA T568B
	1	White/Green	White/Orange
	2	Green	Orange
	3	White/Orange	White/Green
	6	Orange	Green
	4	Blue	
	5	White/Blue	
	7	White/Brown	
	8	Brown	

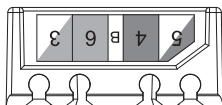
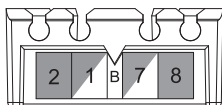

①

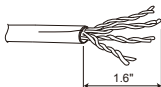

Strip off 1.6 inch of cable jacket.
Fold back the drain wire.

②

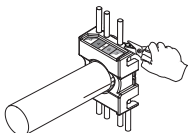

Insert a cable into the termination cap and fan out all four twisted pairs.
Following the instruction of the color-coded wire position printed on the termination cap, position conductors into the slots and make sure the conductors are in the proper slot.
Trim the ends of the conductors.

③

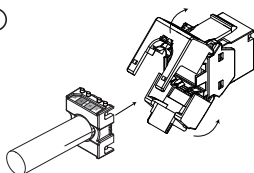

Install the termination cap to outlet, which will also allocate the conductors sitting on the slots.

④

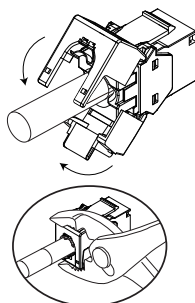

Secure the hinged outlet by using a crimp tool until it completely snap to effect the connection.

⑤

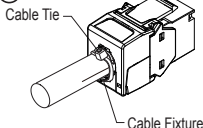

Fasten a cable tie wrap to secure drain wire on the cable fixture.